

Signal tower Ø 54 mm

BR 50



| |
|--------------|
| IP 54 |
|--------------|

Protection system

| |
|--------------|
| IP 65 |
|--------------|

Option

| |
|-----------|
| UL |
|-----------|

| |
|----------------|
| + 50 °C |
| - 25 °C |

Operating temperature

- modular design with sturdy housing for all indoor and outdoor applications in tough conditions
- wherever machine status needs to be displayed and warning signals given
- high protection system IP 54 (optionally IP 65)
- flexible building kit system guarantees easy handling
- up to 5 modules with 6 lens colours can be combined as desired by simply plugging together, even retrospectively
- mechanical and electronic components are uncoupled, resulting in a more stable structure that is less sensitive to vibration
- many different variations are possible, can be fixed by means of tubular stand, tube or direct mounting
- made of environmentally-friendly materials as per DIN ISO 14000
- monitored module for greater safety; the light bulb has two separate LED strands. If one strand fails, the alarm contact is activated and the second strand continues to light

| Technical data | | BR 50 (standard modules) | | | | | |
|--|-----------------------|---|----------------------|-----------------------|----------------------|--|---------------------|
| Modules | | continuous light | | blinking light 1.5 Hz | | flashing light | sounder |
| Colours | | clear, yellow, amber, red, green, blue | | | | | |
| Segment stages (total) | | max. 5 (order and colour can be selected individually) | | | | | |
| Dispersion | | 360° | | | | | |
| Light source ¹ | | bulb BA15d | LED | bulb BA15d | LED | | |
| Rated power | per stage | 7 W | depending on voltage | 7 W | depending on voltage | | |
| | per stage if 5 stages | 5 W | | 5 W | | | |
| Flash energy | 230 V / 115 V AC | | | | | 0.6 J | |
| | 24 V AC/DC | | | | | 24 V: 1 J | |
| Flash frequency | | | | | | approx. 1 Hz | |
| Sound pressure level | | | | | | | 85 dB (A) |
| Alarm tones | | | | | | | 7 |
| Nominal current consumption (50/60 Hz) | 230 V AC | 35 mA | 15 mA | 35 mA | – | 10.5 mA | 15 mA |
| | 115 V AC | 64 mA | 15 mA | – | – | 20 mA | 15 mA |
| | operating range | - 15% ... + 10% | | | | - 10% ... + 15% | - 15% ... + 10% |
| Nominal current consumption | 24 V | DC: 300 mA | DC: 30 mA | DC: 250 mA | DC: 30 mA | AC/DC: 100 mA | 12 mA |
| | operating range | - 15% ... + 20% | | 10 V – 30 V | | AC: 10 V – 27 V DC: 10 V – 35 V | - 15% ... + 20% |
| Operating temperature | with bulb | - 25 °C ... + 50 °C | | - 25 °C ... + 50 °C | | | - 10 °C ... + 45 °C |
| | with LED | - 30 °C ... + 60 °C | | | | | |
| Relative humidity | | 90% | | | | | |
| Protection system according to EN 60529 | | IP 54 | | | | | IP 43 |
| Duty cycle | | 100% | | | | | |
| Service life of light source | | approx. 1 500 h | approx. 50 000 h | approx. 1 500 h | approx. 50 000 h | light emission still 70% after 8 000 000 flashes | |
| Material | base | acrylonitrile butadiene styrene (ABS) | | | | | |
| | lens | polycarbonate (PC) | | | | | |
| | tube | stainless steel | | | | | |
| Tube thread | | 30 mm, M16 x 1,5 | | | | | |
| Mounting | | vertical or horizontal | | | | | |
| Mounting information | | the sounder module or the monitored module is always the uppermost module; a maximum of 1 monitored module may be used per signal tower | | | | | |
| Weight | module | 80 g | | 90 g | | 90 g | 230 g |
| | base | mounting stand: approx. 220 g / tube mounting: approx. 200 g / direct mounting: approx. 180 g | | | | | |

¹ please order light source separately

| Technical data | monitored continuous light module | BR 50 AS-i Bus slave | |
|---|---|--|---------|
| Modules | | AS-i | AS-i-AB |
| Module types | monitored continuous light | LED module, sounder module, continuous light module, blinking light module | |
| Colours | yellow, red | | |
| Segment stages (total) | max. 3 | max. 4 | max. 3 |
| Dispersion | 360° | | |
| Light source | 2 x 8 LED (not exchangeable) | | |
| AS-i profile | | S-8.F.E | S-8.A.E |
| AS-i specification | | AS-i 3.0 / EN 50295 | |
| Programming | | DC-Jack, Ø 1.3 mm | |
| max. slave/master | | 31 | 62 |
| Alarm output | max. 230 V / 80 mA, $R_{ONmax} = 35 \Omega$ (closed at error-free operation) | | |
| Rated power | 24 V DC | | |
| Nominal current consumption | approx. 35 mA | < 0,25 A | |
| Operating range | - 15% ... + 20% | 26.5 V – 31.6 V | |
| Operating temperature | - 30 °C ... + 60 °C | | |
| Relative humidity | 90% | | |
| Protection system according to EN 60529 | IP 54 | | |
| Duty cycle | 100% | | |
| Service life of light source | 50 000 hrs @ 24 °C, 40% R.H. | | |
| Material | base: acrylonitrile butadiene styrene (ABS) lens: polycarbonate (PC) | | |
| Mounting | vertical or horizontal | | |
| Mounting information | the AS-i / AS-i-AB module is always used as the lowest module | | |
| Weight | 90 g | 90 g | |

Connection and configuration options for monitored modules

- Use of one monitored module per signal tower:
 - configuration as „top“ module (top module is monitored)
 - configuration as „bottom“ module (bottom module is monitored)
- Use of 2 monitored modules per signal tower

Configuration as „top“ module (top module is monitored)

| Base module + 1 st stage monitored | | Base module + 1 st stage not monitored, 2 nd stage monitored | | Base module + 1 st /2 nd stage not monitored, 3 rd stage monitored | |
|---|--|--|---|---|---|
| -/N | supply voltage (-), common connection for all stages | -/N | supply voltage (-), common connection for all stages | -/N | supply voltage (-), common connection for all stages |
| 1+/L | supply voltage (+), activation of monitored module | 1+/L | supply voltage (+), activation of 1 st stage | 1+/L | supply voltage (+), activation of 1 st stage |
| 2+/L | potential-free alarm output contact 1 | 2+/L | supply voltage (+), activation of 2 nd stage (monitored) | 2+/L | supply voltage (+), activation of 2 nd stage |
| 3+/L | potential-free alarm output contact 2 | 3+/L | potential-free alarm output contact 1 | 3+/L | supply voltage (+), activation of 3 rd stage (monitored) |
| 4+/L | n.c. | 4+/L | potential-free alarm output contact 2 | 4+/L | potential-free alarm output contact 1 |
| 5+/L | n.c. | 5+/L | n.c. | 5+/L | potential-free alarm output contact 2 |

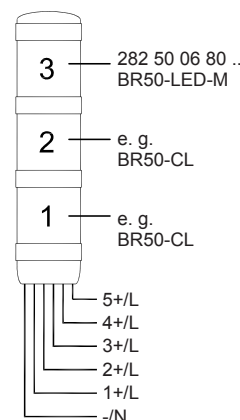
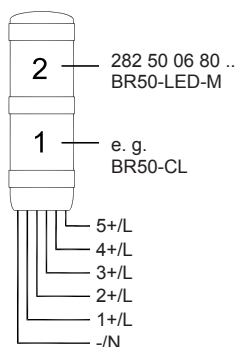
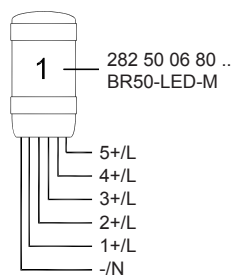

Configuration as „bottom“ module (bottom module is monitored)

| Base module + 1 st stage monitored | | Base module + 1 st stage monitored, 2 nd stage not monitored | | Base module + 1 st stage monitored, 2 nd /3 rd stage not monitored | |
|---|--|--|---|---|---|
| -/N | supply voltage (-), common connection for all stages | -/N | supply voltage (-), common connection for all stages | -/N | supply voltage (-), common connection for all stages |
| 1+/L | supply voltage (+), activation of monitored module | 1+/L | supply voltage (+), activation of 1 st stage (monitored) | 1+/L | supply voltage (+), activation of 1 st stage (monitored) |
| 2+/L | n.c. | 2+/L | supply voltage (+), activation of 2 nd stage | 2+/L | supply voltage (+), activation of 2 nd stage |
| 3+/L | n.c. | 3+/L | n.c. | 3+/L | supply voltage (+), activation of 3 rd stage |
| 4+/L | potential-free alarm output contact 1 | 4+/L | potential-free alarm output contact 1 | 4+/L | potential-free alarm output contact 1 |
| 5+/L | potential-free alarm output contact 2 | 5+/L | potential-free alarm output contact 2 | 5+/L | potential-free alarm output contact 2 |

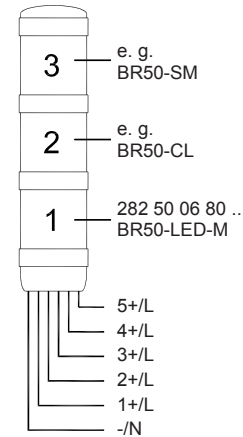
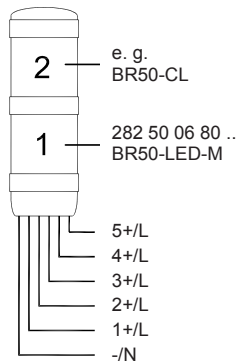
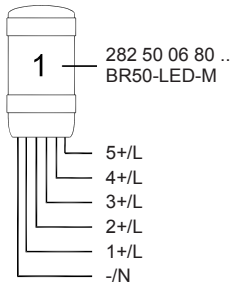

Use of 2 monitored modules per signal tower

| Base module + 1 st /2 nd stage monitored | |
|--|---|
| -/N | supply voltage (-), common connection for all stages |
| 1+/L | supply voltage (+), activation of 1 st stage (monitored) |
| 2+/L | supply voltage (+), activation of 2 nd stage (monitored) |
| 3+/L | alarm output module 2 |
| 4+/L | common connection alarm outputs |
| 5+/L | alarm output module 1 |

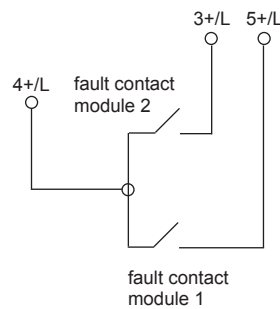
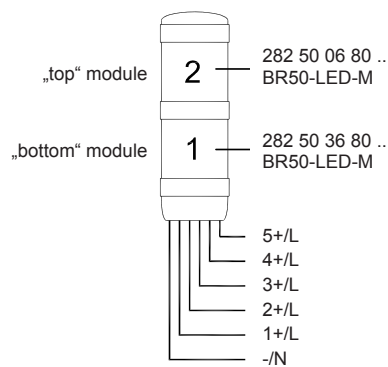

The alarm outputs of both levels have a shared contact!

Caution: Max. 2 modules can be utilized

Dimensions

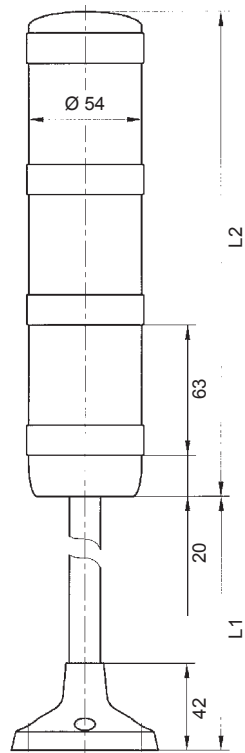

| | L1 tube mounting | L1 mounting stand |
|-----------------|------------------|-------------------|
| Tube length 100 | 78 | 88 |
| Tube length 250 | 228 | 238 |
| Tube length 400 | 378 | 388 |
| | L2 | |
| 1-stage | 107 | |
| 2-stage | 170 | |
| 3-stage | 233 | |
| 4-stage | 296 | |
| 5-stage | 359 | |

Stand mounting gasket

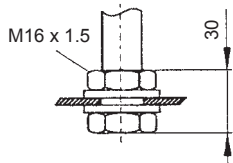
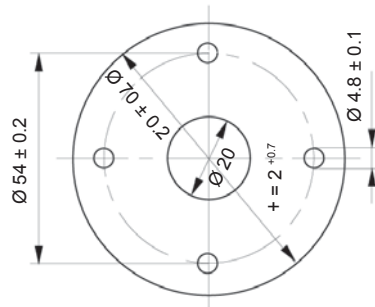

Bayonet connection allows fast, simple and safe mounting



Configuration alternatives



| Ordering details | | | | | |
|---|---------------|---------------|-----------------|-----------------|-----------------|
| Article numbers | | | BR 50 modules | | |
| Version | Rated voltage | | 230 V AC | 115 V AC | 24 V DC |
| Base and end module | BR50-BC | | 282 50 01 0 000 | | |
| Continuous light module | clear | BR50-CL-CL | 282 50 04 0 010 | | |
| | yellow | BR50-CL-YE | 282 50 04 0 030 | | |
| | amber | BR50-CL-AM | 282 50 04 0 040 | | |
| | red | BR50-CL-RE | 282 50 04 0 050 | | |
| | green | BR50-CL-GR | 282 50 04 0 060 | | |
| | blue | BR50-CL-BL | 282 50 04 0 070 | | |
| Blinking light module | clear | BR50-BL-CL | 282 50 05 1 010 | 282 50 05 1 610 | 282 50 05 8 010 |
| | yellow | BR50-BL-YE | 282 50 05 1 030 | 282 50 05 1 630 | 282 50 05 8 030 |
| | amber | BR50-BL-AM | 282 50 05 1 040 | 282 50 05 1 640 | 282 50 05 8 040 |
| | red | BR50-BL-RE | 282 50 05 1 050 | 282 50 05 1 650 | 282 50 05 8 050 |
| | green | BR50-BL-GR | 282 50 05 1 060 | 282 50 05 1 660 | 282 50 05 8 060 |
| | blue | BR50-BL-BL | 282 50 05 1 070 | 282 50 05 1 670 | 282 50 05 8 070 |
| Flashing light module | clear | BR50-FL-CL | 282 50 07 1 010 | 282 50 07 1 610 | 282 50 07 8 010 |
| | yellow | BR50-FL-YE | 282 50 07 1 030 | 282 50 07 1 630 | 282 50 07 8 030 |
| | amber | BR50-FL-AM | 282 50 07 1 040 | 282 50 07 1 640 | 282 50 07 8 040 |
| | red | BR50-FL-RE | 282 50 07 1 050 | 282 50 07 1 650 | 282 50 07 8 050 |
| | green | BR50-FL-GR | 282 50 07 1 060 | 282 50 07 1 660 | 282 50 07 8 060 |
| | blue | BR50-FL-BL | 282 50 07 1 070 | 282 50 07 1 670 | 282 50 07 8 070 |
| LED module, monitored (top module) | yellow | BR50-LED-M-YE | – | – | 282 50 06 8 030 |
| | red | BR50-LED-M-RE | – | – | 282 50 06 8 050 |
| LED module, monitored (bottom module) | yellow | BR50-LED-M-YE | – | – | 282 50 36 8 030 |
| | red | BR50-LED-M-RE | – | – | 282 50 36 8 050 |
| Sounder module | BR50-SM | | 282 50 08 1 000 | 282 50 08 1 600 | 282 50 08 8 000 |
| AS-i module | BR50-AS-i | | 282 50 14 8 300 | | |
| AS-i-AB module | BR50-AS-i-AB | | 282 50 17 8 300 | | |
| Information module | BR50-IM | | 282 50 27 0 000 | | |
| Tubular stand with plinth | 100 mm | BR50-S100 | 282 50 15 0 010 | | |
| | 250 mm | BR50-S250 | 282 50 15 0 020 | | |
| | 400 mm | BR50-S400 | 282 50 15 0 040 | | |
| Tube with thread and bracket (excl. seal and cable) | 100 mm | BR50-T100 | 282 50 16 0 010 | | |
| | 250 mm | BR50-T250 | 282 50 16 0 020 | | |
| | 400 mm | BR50-T400 | 282 50 16 0 040 | | |

Light bulbs for constant light and blinking light modules must be ordered separately

Options / Accessories



Article number:
282 50 25 0 000



Article number:
282 50 20 0 000

for mounting stand



Article number:
282 50 21 0 000

for direct mounting



Article number:
282 50 22 0 000
282 50 23 0 000



Light source



See pages 188/189 for further information

Ordering example

| Signal tower 5-stage, IP 65 | Article numbers | | |
|---|-------------------|-----------------|-----------------|
| | Version | 230 V AC | 24 V DC |
|  <p>Sounder module</p> | BR50-SM | 282 50 08 1 000 | 282 50 08 8 000 |
| + | | | |
|  <p>Flashing light module</p> | BR50-MG | 282 50 22 0 000 | |
| | + | | |
| | BR50-FL | 282 50 07 1 050 | 282 50 07 8 050 |
| + | | | |
|  <p>Continuous light module with bulb or LED</p> | BR50-MG | 282 50 22 0 000 | |
| | + | | |
| | BR50-CL | 282 50 04 0 060 | |
| | + | | |
| | bulb | 282 13 00 0 004 | 282 13 00 0 000 |
| | or | | |
| | LED BA 15d | 282 13 00 0 018 | 282 13 00 0 011 |
| + | | | |
|  <p>Blinking light module with bulb or LED</p> | BR50-MG | 282 50 22 0 000 | |
| | + | | |
| | BR50-BL | 282 50 05 1 030 | 282 50 05 8 030 |
| | + | | |
| | bulb | 282 13 00 0 004 | 282 13 00 0 000 |
| | or | | |
| | LED BA 15d | 282 13 00 0 030 | 282 13 00 0 007 |
| + | | | |
|  <p>Continuous light module with bulb or LED</p> | BR50-MG | 282 50 22 0 000 | |
| | + | | |
| | BR50-CL | 282 50 04 0 010 | |
| | + | | |
| | bulb | 282 13 00 0 004 | 282 13 00 0 000 |
| | or | | |
| | LED BA 15d | 282 13 00 0 014 | 282 13 00 0 006 |
| | + | | |
| | BR50-MG | 282 50 22 0 000 | |
| | + | | |
| | BR50-BC | 282 50 01 0 000 | |
| + | | | |
|  <p>Mounting stand (100 mm) and seal</p> | BR50-TG | 282 50 23 0 000 | |
| | | | |
| | BR50-S100 | 282 50 15 0 010 | |