

# FICHA DEL PRODUCTO

ITEM:

Interrupor MCCB 4P XT7S M 1600 640-1600A LS/I 50kA Ekip Dip

CÓDIGO:

0710101657AB

IMAGEN:



DESCRIPCIÓN  
APLICACIÓN:

La unidad de control compacta recopila datos de dispositivos de campo, a los que se puede acceder a través del servidor web InSite o cualquier aplicación de terceros, gracias a sus capacidades de exportación de datos a través de Modbus TCP, Rest API. Dependiendo de las necesidades específicas, los módulos de expansión se pueden seleccionar entre una variedad de opciones, lo que permite personalizar el sistema de una manera rentable y compacta.

## Características

- Aplicación: Gestión de energía y calidad de energía en distribución secundaria y final
- Voltaje de alimentación: 24 VDC
- Consumo de energía: 15 W
- Corriente nominal: 0,7 A
- Interfaz de comunicación: EthernetRS485Bus InSite (cable plano)
- Protocolos: Modbus RTU, Modbus TCP/IP, REST API, DHCP, HTTPS, NTP

## Capacidad de conexión

- Hasta 32 dispositivos por cable plano (sensores de corriente, módulos de E/S, auxiliares inteligentes)
- Hasta 16 dispositivos Modbus RTU
- Hasta 16 dispositivos Modbus TCP

## Compatibilidad y expansión

- Compatible con accesorios y módulos de expansión del ecosistema InSite Pro
- Acceso a datos vía servidor web InSite o aplicaciones de terceros

## Compatible

27131010AB Fuente alimentación INS-PS-1 15W para SCU200

# Contact us

ABB S.p.A.  
V.le dell'Industria, 18  
20009 Vittuone (MI) Italy  
<https://new.abb.com/low-voltage>



Warning! Installation by person with electrotechnical expertise only.  
Warnung! Installation nur durch elektrotechnische Fachkraft.  
Avvertenza! Fare installare solo da un elettricista qualificato.



QR Code for online Installation Manual.

© Copyright 2025 ABB S.p.A. All rights reserved. Specification subject to change without notice.

## 1. Packaging Content

- Control unit SCU200 / SCU200-W
- Installation manual

## 2. Product overview

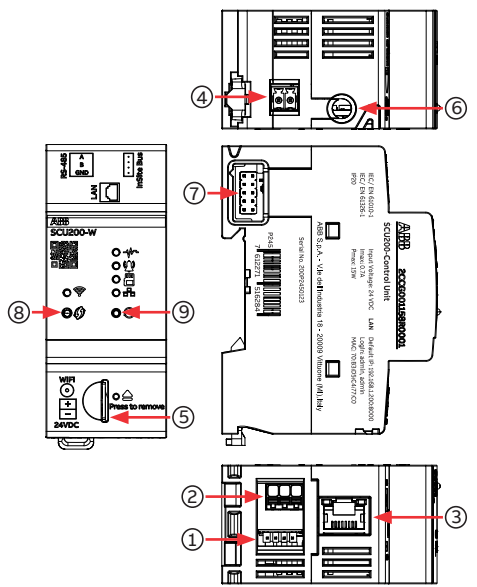

Description
1 InSite bus interface
2 RS-485 (2-wire)
3 RJ45 LAN port
4 Connection port to 24 VDC
5 microSD slot
6 SMA connector (only on SCU200-W)
7 Modular bus connector (input)
8 WPS button
9 Reset button

## 3. SCU200 on 35mm DIN-Rail

### 3.1. Assembly on DIN-Rail

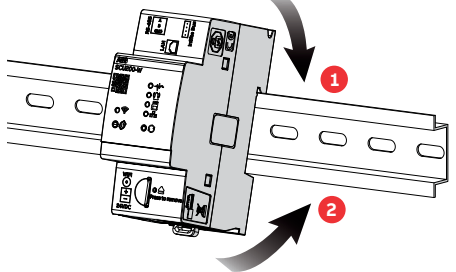

### 3.2. Disassembly on DIN-Rail

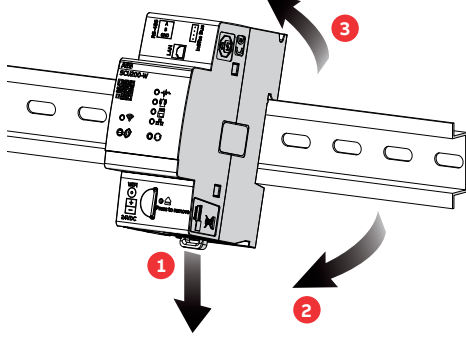

9AKK108467A9129-E May 2025

## InSite energy management system INSTALLATION MANUAL

InSite control unit  
SCU200 / SCU200-W

## 4. Connection diagram

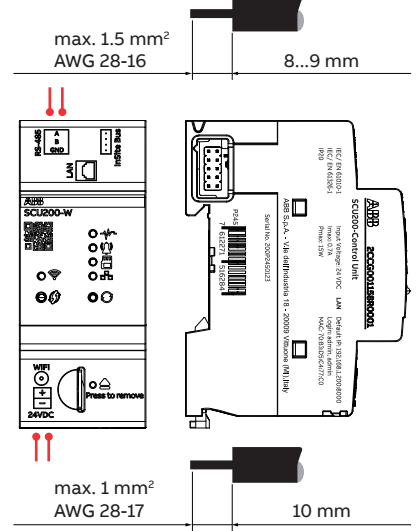

To power the SCU200 with 24VDC, first connect cables to the adapter, and then plug it into the 24VDC connection port paying attention not to force the insertion too much.

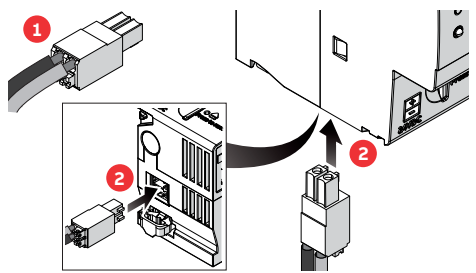

## 5. Connection to current sensors, I/O modules and smart accessories

- Use the connectors only once.
- Keep a distance of 5.5mm minimum between the flat cable and uninsulated live parts.
- Consider the maximum flat cable length. To calculate maximum length, please refer to the tool available at this link.



QR Code for online tool.

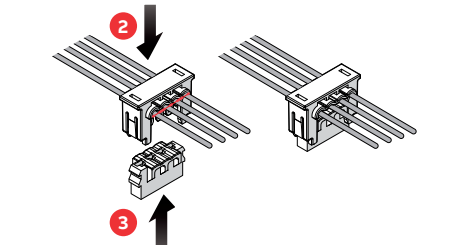
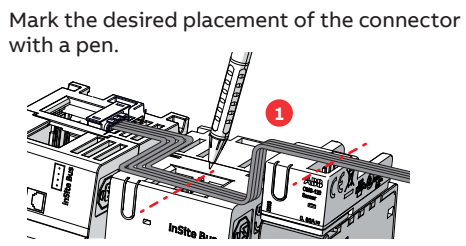

**Attention:** Please ensure the connector pin is locked into the socket. For proper locking the socket edges are at the level of connector.



Press connector set with parallel pliers together.

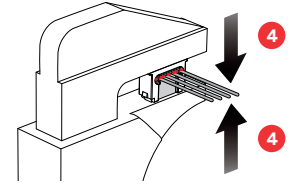

Plug connectors to Control Unit and sensors, I/O modules and/or smart devices.

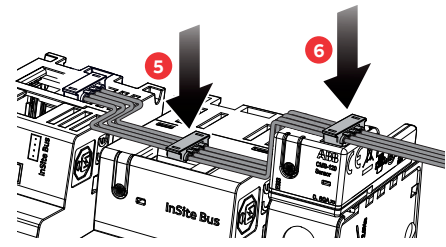

## 5.1. Mounting of current sensors

Refer to dedicated instruction manuals or InSite user manual



QR Code for 2CCC481010M1003 (Open-Core sensor)



QR Code for 2CCC481009M1001 (Solid-Core sensor)

## 5.2. Mounting of I/O modules

Refer to dedicated instruction manuals or InSite user manual.



QR Code for 9AKK107680A1728 (Instructions for I/O modules)

## 5.3. Mounting of smart accessories

Refer to dedicated instruction manuals or InSite user manual.



QR Code for 9AKK107680A1728 (Instructions for I/O modules)

## 6. Connection of InSite expansion modules

To connect expansion modules remove the flap covering the input connectors of SCU200

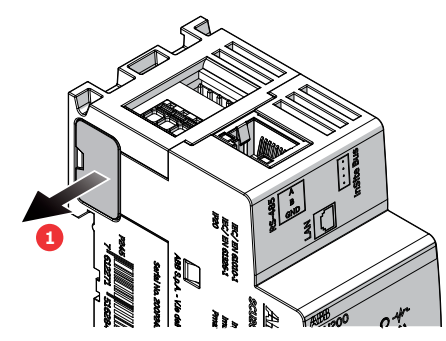

and insert the connector plug placed on the right side of the InSite expansion module. Pay attention to the correct interlocking between modules.

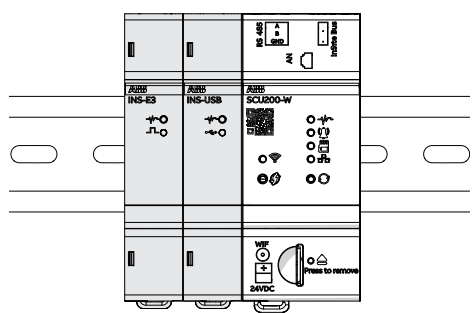
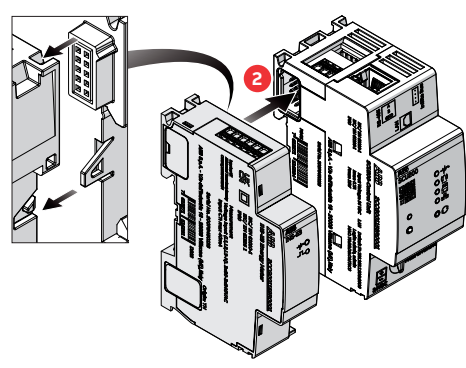

**Attention:** In case one or more expansion modules have to be added to SCU200 / SCU200-W plug them all first before assembling on DIN-Rail bar.

## 7. Connection to LAN

The SCU200 control unit can be connected to the router using a RJ45 cable. In case of SCU200-W connection can also be done through WiFi, by pressing the WPS button on both router (first) and control unit or selecting the correct network in the WebUI "System setup - Communication - Wifi" section and typing the correspondent password if needed.

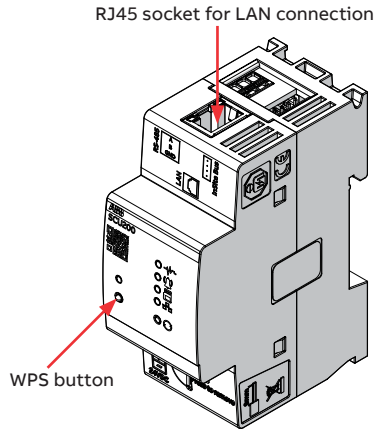

If wired connection through RJ45 is selected:

Static access with default factory setting	Details
1 Static IP address for PC	<a href="https://192.168.1.x">https://192.168.1.x</a> (x=2...254)
2 Subnet mask	255.255.255.0
3 DHCP access (In case: If you change after initial commissioning for DHCP access)	Hostname: insite
4 Web browser to access web User Interface	Google Chrome
5 Default IP of Control Unit	<a href="https://192.168.1.200:8000">https://192.168.1.200:8000</a>
6 Default login	admin, admin

**Information:** Make sure that IP address in assigned LAN is not used twice, if needed adjustment is required. Example: <https://192.168.1.x> (x=2...254)

In case of cable extension (antenna connected to the cabinet), be sure to isolate the antenna from the ground (e.g. using a panel-mounted isolated SMA connector).

**Attention:** Antenna shields are connected to common system ground. Connecting antenna shields to different potentials may damage the system or result in protection means trip.

If wireless connection is selected:

Wireless access with default factory setting	Details
1 IP address for PC	DHCP
2 WiFi network	SSID: see product label
3 SSID password	See product label
4 Default IP of Control Unit	<a href="https://192.168.2.1:8000">https://192.168.2.1:8000</a>
5 Default login	admin, admin

## 8. Setting and configuration

Detailed explanation to access web User Interface is reported in section "5. Access to control unit and configuration wizard" of the user manual. How to configure the system is detailed in section "6. WebUI" of the user manual.



Download User Manual.