

FICHA DEL PRODUCTO

ITEM:

Fusible Ø 8.5x31.5mm, curva gG/gL 2A 500V 100KA

CÓDIGO:

2109002CH

IMAGEN:



DESCRIPCIÓN

APLICACIÓN:

RT29

Fusible

La serie de fusibles RT cuentan con un diseño compacto, peso ligero, bajo consumo de energía y de alta capacidad de ruptura.

Uso: Para protección de aparatos eléctricos contra sobrecarga y cortocircuito.

Características técnicas

- Condiciones de trabajo: AC 500V, hasta 125A
- Valores máximos de trabajo: 500V 100 kA
- Curva: gG/gl
- Norma: IEC 60269

CE

WWW.NDU.CL

Información Técnica y Dimensiones

| Model | Rated voltage (V) | Rated current (A) | Power consumption (W) | Breaking capacity (kA) | Dimension(mm) B×A | Weight (Kg) |
|----------|-------------------|----------------------------------|-----------------------|------------------------|-------------------|-------------|
| RT29-16 | 500V | 2, 4, 6, 8, 10, 16 | ≤2.5 | 100 | 8.5×31.5 | 0.0045 |
| RT28-32 | 500V | 2, 4, 6, 8, 10, 16, 20, 25, 32 | ≤3 | 100 | 10×38 | 0.009 |
| RT28-63 | 500V | 10, 16, 20, 25, 32, 40, 50, 63 | ≤5 | 100 | 14×51 | 0.022 |
| RT29-125 | 500V | 25, 32, 40, 50, 63, 80, 100, 125 | ≤9.5 | 100 | 22×58 | 0.06 |

2.1 Fuse holder

| Model | Matched fuse holder | Rated current (A) | Weight (Kg) |
|----------|-------------------------|-------------------|-------------|
| RT29-16 | RT29-16 | 16 | 0.035 |
| RT29-16D | RT29-16D | 16 | 0.040 |
| RT29-32 | RT14-20, RT28-32 | 32 | 0.06 |
| RT29-63 | RT28-63 | 63 | 0.07 |
| RT29-125 | RT14-63(≤63A), RT29-125 | 125 | 0.13 |

RT29-32

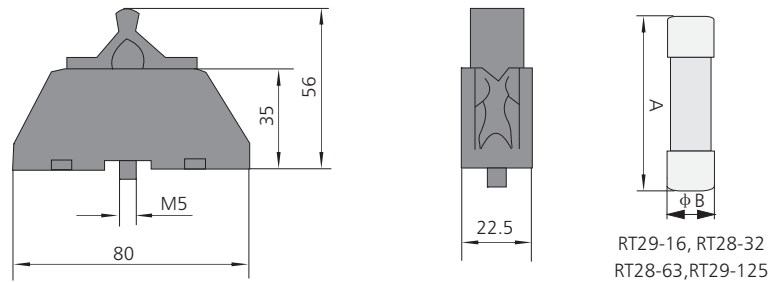

RT29-63

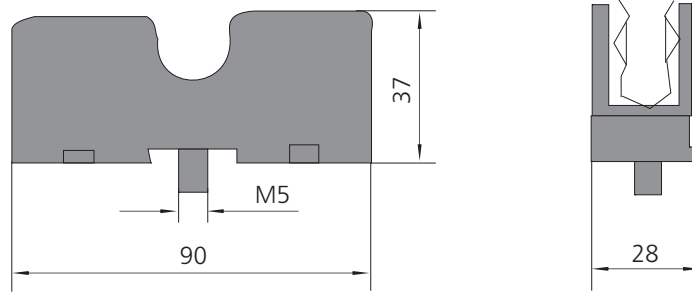

RT29-16

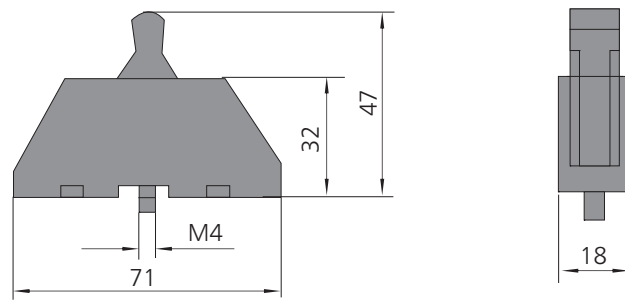

RT29-16D

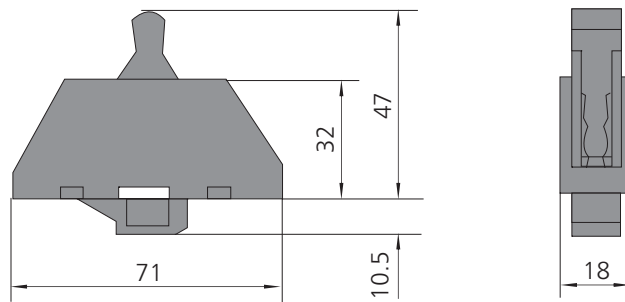

RT29-125

